

HARRIS COUNTY

OFFICE OF THE COUNTY ENGINEER

1001 Preston, Suite 500
Houston, Texas 77002
(713) 755-5370

April 14, 2021

Honorable County Judge
& Commissioners

SUBJECT: SOLS/PMUB – 5995 ½ Old Greenhouse Rd

Recommendation that the County Judge execute a service outlet location statement for installation of an electric meter with CenterPoint Energy Houston Electric, LLC and authorize the County Auditor to pay monthly utility bills at 5995 ½ Old Greenhouse Rd (intersection of Gummert Rd at Barker Cypress Rd) for electrical power serving a traffic signal, Precinct 4.

Sincerely,



John R. Blount, P.E.
County Engineer

Attachment

cc: Commissioner R. Jack Cagle
Cheryl Guenther
Pamela Rocchi
Freddie Jebousek
Dennis Johnston
Kiley Holbrook



SERVICE OUTLET LOCATION AND DATA STATEMENT FOR ELECTRIC SERVICE

CNP 79 (9-2019) Page 1 of 3

CUSTOMER Harris County	DAY PHONE 713-247-3600
SERVICE ADDRESS 5995 1/2 Old Greenhouse Rd, Katy, TX 77449	EVENING PHONE
MAILING ADDRESS 1001 Preston Street 7th Floor Houston, TX 77002	CELL PHONE
ELECTRICIAN ESID: 1008901025000984020121	ELECTRICIAN'S PHONE

Dear Customer,

CenterPoint Energy Houston Electric, LLC is grateful to meet with you on, 12-11-2020 to discuss the requirements needed to provide you electric service. DATE

<ul style="list-style-type: none">CenterPoint Energy Construction Required? <input checked="" type="checkbox"/> YES <input type="checkbox"/> NOThe following steps must be complete prior to construction:<ul style="list-style-type: none"><input type="checkbox"/> Pay any up-front contributions for non-standard service \$ _____<input type="checkbox"/> Clear trees along extension route<input type="checkbox"/> Easement charges \$ _____<input type="checkbox"/> Easement execution	To begin the process we request that you provide the following information: <ul style="list-style-type: none"><input type="checkbox"/> Site Plan and Elevation Plan: Hard Copies<input type="checkbox"/> Site Plan: Electronic Copy with XY Coordinates<input type="checkbox"/> One Line Diagram<input type="checkbox"/> Load Analysis<input type="checkbox"/> Easements Required-Recorded Warranty Deed Required<input type="checkbox"/> Specifications on Modular Metering Enclosure.
--	--

The following steps must be completed prior to meter installation:

YES NO

- | | | |
|-------------------------------------|--------------------------|---|
| <input checked="" type="checkbox"/> | <input type="checkbox"/> | Installation of meter pole or weather head (as located on sketch) |
| <input checked="" type="checkbox"/> | <input type="checkbox"/> | Obtain city or county permit - For contact information, call 713-207-2222 or 1-800-332-7143, or visit the website http://www.centerpointenergy.com/houston/builders |
| <input checked="" type="checkbox"/> | <input type="checkbox"/> | Obtain an ESI ID# for your account - Either you the customer or your Competitive Retailer can get this number by calling 713-207-2222 or 1-800-332-7143 |
| <input checked="" type="checkbox"/> | <input type="checkbox"/> | Choose a Competitive Retailer - For listing, visit the website http://www.powertochoose.org or call 1-866-PWR-4-TEX(1-866-797-4839) |

Want to start gas service? Go to move.centerpointenergy.com/move or call 800-752-8036
To learn more about energy efficiency programs, please visit centerpointefficiency.com

CenterPoint Energy Houston Electric, LLC's target completion date to provide your construction requirements, per the working sketch, is a mutually agreed upon negotiated date by CenterPoint Energy and customer. *Please be aware our ability to meet the target completion date may be affected by weather, availability of construction crews and materials, ability to secure easements, and timely completion of your requirements (see above).* **In addition, as a condition to this service, you agree to comply with all of CenterPoint Energy standards, the National Electrical Code, the National Safety Code, all Occupational Safety and (OSHA) requirements, the International Building code and all local governing body codes.**

We appreciate the opportunity to do business with you and look forward to the successful completion of this project. Your signature below insures that both parties understand the requirements toward completion that will allow you electrical service. Thanks for your cooperation in this matter.

Sincerely,

Service Consultant

SERVICE CONSULTANT Urbano Anzaldúa Jr	PHONE NUMBER (281) 391-5150
ADDRESS 5431 Hwy Blvd, Katy, TX 77492	
E-MAIL ADDRESS urbano.anzalduejr@centerpointenergy.com	

CUSTOMER'S SIGNATURE

CUSTOMER'S PRINTED NAME

DATE

YES NO

- | | | |
|--------------------------|-------------------------------------|---|
| <input type="checkbox"/> | <input checked="" type="checkbox"/> | Will Customer have Back-up Generation? |
| <input type="checkbox"/> | <input checked="" type="checkbox"/> | Will Customer have Motor Greater than 250 HP? |

APPLICABLE FORMS

- ☐ Power Quality
- ☐ Primary Meter
- ☐ Motor Start
- ☐ Emergency Generation
- ☐ Distributed Generation
- ☐ Major UG Checklist

<p align="center">GENERAL SERVICE</p> <p> <input type="checkbox"/> 1Ø 3W 120/208 <input checked="" type="checkbox"/> 1Ø 3W 120/240 <input type="checkbox"/> 3Ø 4W Δ 240V <input type="checkbox"/> 3Ø 4W Y 120/208V <input type="checkbox"/> 3Ø 4W Y 277/480V* *10 X 26 PT can mounted on 480V Service? <input type="checkbox"/> 3Ø 3W Δ 480V* *1-1/4" conduit connecting CT & PT can run? <input type="checkbox"/> Primary Metering Job <input type="checkbox"/> Major UG Job <input type="checkbox"/> Other: (Explain) _____ _____ </p>		<p align="center">SERVICE TYPE</p> <p> _____ FT² <input checked="" type="checkbox"/> All Electric <input type="checkbox"/> Gas & Electric Size Wire Pulled _____ Cust's Load 1 Ø <u>25</u> +3 Ø _____ = <u>25</u> Total KVA Fault Current: Initial <u>6,100</u> Ultimate <u>99,200</u> Amperes RMS Symmetrical at <u>240</u> Volts </p>	
<p align="center">CT CAN TYPE</p> <p> <input type="checkbox"/> 320 Amp (self contained) <input type="checkbox"/> 30 X 42 <input type="checkbox"/> Bus Head Outdoor <input type="checkbox"/> Bus Head with CT Can <input type="checkbox"/> Stainless Steel Rack <input type="checkbox"/> Primary Job </p>	<p align="center">CONDUITS ON POLE</p> <p> Size of Conduit _____ No. of Conduits _____ </p>	<p align="center">For Information Regarding:</p> <p align="center"> CenterPoint Energy service standards visit www.centerpointenergy.com/electricservicestandards For approvals on AUTOMATIC TRANSFER SWITCHES EMAIL SPECS TO ATS.Approvals@CenterPointEnergy.com </p>	

COMMENTS OR NOTES

CNP to upgrade/install poles for new traffic signals at 5995 1/2 Old Greenhouse Rd, Katy, TX . CNP to install 120/240v overhead transformer. Customer to install meter pole and underground service lateral; pipe up beneath CNP transformer and maintain 6" clearance below transformer or lowest secondary conductor. Customer will comply with CNP standards and all applicable NEC requirements.

ILLUSTRATION

see separte sketch provided

LEGEND

- X Proposed Pole
- O Existing Pole
- ☐ Meter Pole
- Proposed Wire

**TEXAS LAW AN ACT
TEXAS HEALTH AND SAFETY CODE TITLE 9**

CHAPTER 752 - Safety of persons engaged in activities in proximity of high voltage electric lines; restrictions

SECTION 001. DEFINITIONS

(1) "High voltage" means more than 600 volts measured between conductors or between a conductor and the ground.

(2) "Overhead line" means a bare or insulated electric conductor installed above ground but does not include a conductor that is de-energized and grounded or that is enclosed in a rigid metallic conduit.

SECTION 002. EXEMPTION FOR CERTAIN EMPLOYEES AND ACTIVITIES

(A) This chapter does not apply to the construction, reconstruction, operation, or maintenance by an authorized person of overhead electrical or communication circuits or conductors and their supporting structures and associated equipment that are part of a rail transportation system, an electrical generating, transmission, or distribution system or a communication system.

(B) In this section, "authorized person" means:

(1) an employee of a light and power company, an electric cooperative, or a municipality working on his employer's electrical system;

(2) an employee of a transportation system working on the system's electrical circuits;

(3) an employee of a communication utility;

(4) an employee of a state, county, or municipal agency that has authorized circuit construction on the poles or structures that belong to an electric power company, an electric cooperative, a municipal or transportation system, or a communication system;

(5) an employee of an industrial plant who works on the plant's electrical system; or

(6) an employee of an electrical or communications contractor who is working under the contractor's supervision.

SECTION 003. TEMPORARY CLEARANCE OF LINES

(A) A person, firm, corporation, or association responsible for temporary work or a temporary activity or function closer to a high voltage overhead line than the distances prescribed by this chapter must notify the operator of the line at least 48 hours before the work begins.

(B) A person, firm, corporation, or association may not begin the work, activity, or function under this section until the person, firm, corporation, or association responsible for the work, activity, or function and the owner or operator, or both, of the high voltage overhead line have negotiated a satisfactory mutual arrangement to provide temporary de-energization and grounding, temporary relocation or raising of the line, or temporary mechanical barriers to separate and prevent contact between the line and the material or equipment or the person performing the work, activity or function.

(C) The person, firm, corporation, or association responsible for the work, activity, or function shall pay the operator of the high voltage overhead line the actual expense incurred by the operator in providing the clearance prescribed in the agreement. The operator may require payment in advance and is not required to provide the clearance until the person, firm, corporation, or association responsible for the work, activity, or function makes the payment.

(D) If the actual expense of providing the clearance is less than the amount paid, the operator of the high voltage overhead line shall refund the surplus amount.

SECTION 004. RESTRICTION ON ALL ACTIVITIES NEAR LINES

(A) Unless a person, firm, corporation, or association effectively guards against danger by contact with the line as prescribed by Section 752.003, the person, firm, corporation, or association, either individually or through an agent or employee, may not perform a function or activity on land, a building, a highway, or other premises if at any time it is possible that the person performing the function or activity may:

(1) move or be placed within six feet of a high voltage overhead line while performing the function or activity; or

(2) bring any part of a tool, equipment, machine, or material within six feet of a high voltage overhead line while performing the function or activity.

(B) A person, firm, corporation, or association may not require an employee to perform a function or activity prohibited by Subsection (A).

SECTION 005. RESTRICTION ON OPERATION OF MACHINERY AND PLACEMENT OF STRUCTURES NEAR LINES

Unless a person, firm, corporation, or association effectively guards against danger by contact with the line as prescribed by Section 752.003, the person, firm, corporation, or association, either individually or through an agent or employee, may not:

(1) erect, install, transport, or store all or any part of a house, building, or other structure within six feet of a high voltage overhead line;

(2) install, operate, transport, handle, or store all or any part of a tool, machine, or equipment within six feet of a high voltage overhead line; or

(3) transport, handle, or store all or any part of supplies or materials within six feet of a high voltage overhead line.

SECTION 006. RESTRICTION ON OPERATION OF CERTAIN MACHINERY OR EQUIPMENT

(A) A person, firm, corporation, or association, individually, through an agent or employee, or as an agent or employee, may not operate a crane, derrick, power shovel, drilling rig, hayloader, haystacker, mechanical cotton picker, pile driver, hoisting equipment, or similar apparatus any part of which is capable of vertical, lateral, or swinging motion unless:

(1) a warning sign is posted and maintained as prescribed by Subsections (B) and (C);

(2) an insulated cage-type guard or protective device is installed about the boom or arm of the equipment, except a backhoe or dipper; and

(3) each lifting line, if the equipment includes a lifting hook device, is equipped with an insulator link on the lift hook connection.

(B) The warning sign required by Subsection (A) (1) must be a weather-resistant sign of not less than five inches by seven inches with a yellow background and black lettering that reads:

"WARNING -- UNLAWFUL TO OPERATE THIS EQUIPMENT WITHIN TEN FEET OF HIGH VOLTAGE LINES."

(C) The warning sign must be legible at 12 feet and placed:

(1) within the equipment so that it is readily visible to the equipment operator while at the equipment controls; and

(2) on the outside of the equipment in the number and location necessary to make it readily visible to a mechanic or other person engaged in the work.

(D) Notwithstanding the distance limitations prescribed by Sections 752.004 and 752.005, unless a person, firm, corporation, or association effectively guards against danger by contact with the line as prescribed by Section 752.003, the person, firm, corporation, or association may not operate all or any part of a machine or equipment described by this section within 10 feet of a high voltage overhead line.

SECTION 007. CRIMINAL PENALTY

(A) A person, firm, corporation, or association or an agent or employee of a person, firm, corporation, or association commits an offense if the person, firm, corporation, association, agent, or employee violates this chapter.

(B) An offense under this section is punishable by a fine of not less than \$100 or more than \$1,000, confinement in jail for not more than one year, or both.

SECTION 008. LIABILITY FOR DAMAGES

If a violation of this chapter results in physical or electrical contact with a high voltage overhead line, the person, firm, corporation, or association that committed the violation is liable to the owner or operator of the line for all damages to the facilities and for all liability that the owner or operator incurs as a result of the contact.

Acts 1989, 71st Leg., ch. 678, § 1, eff. Sept. 1, 1989

Prior Laws:

Acts 1971, 62nd Leg., p. 76, ch. 41.

Vernon's Ann. Civ. St. art. 1436c, § 7(B).

This is only a part of the entire act. The complete act is available for review.

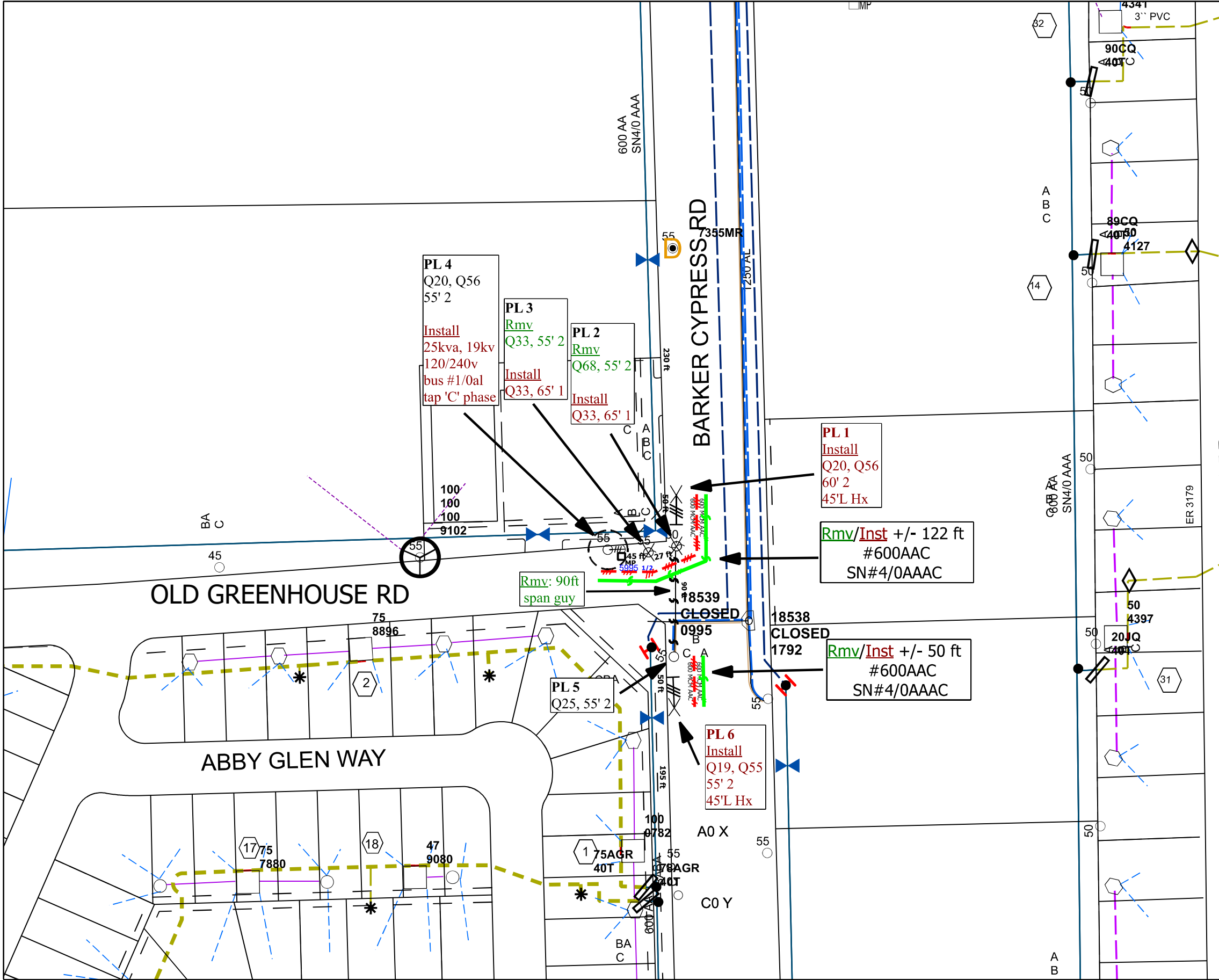

LEGEND

OVERHEAD CONSTRUCTION

EXISTING O/H PRIMARY

PROPOSED O/H PRIMARY

EXISTING POLE

PROPOSED WOOD POLE

EXISTING DOWN GUY AND ANCHOR

PROPOSED DOWN GUY AND ANCHOR

PROPOSED OVERHEAD TRANSFORMER

UNDERGROUND CONSTRUCTION

EXISTING U/G PRIMARY

PROPOSED U/G PRIMARY

EXISTING U/G SECONDARY

PROPOSED U/G SECONDARY

PROPOSED STREET LIGHT SECONDARY

EXISTING PULLHOLE

PROPOSED PULLHOLE

EXISTING PMT

PROPOSED PMT

T ? DENOTES TRANSFORMER NUMBER

EXISTING SECONDARY PEDESTAL

PROPOSED SECONDARY PEDESTAL

CenterPoint Energy

NOTES:

Harris County

WORK ORDER

96365192

CIRCUIT ID NUMBER

GE49

ORDER TYPE

HDC2

WORK CENTER

Katy

FUNCTIONAL LOC.

DIS-022506-OVH

MAINT ACT TYPE

246

GLN

466132

KEY MAP

407X

FIELD TECH/Comp Date

Service Address :

5995 1/2 Old Greenhouse Rd

Consultant :

Urbano Anzaldúa Jr

Phone # :

281-391-5150

Mobile # :

Scale : 1" =

Date Requested :