



March 11, 2025

Subject: Street Light Agreement Letter  
William Tell  
Humble Service Area

Dear Street Lighting Requester:

CenterPoint Energy (Company) agrees to furnish, install, own and maintain street lighting service in the above noted area subject to the Lighting Services Rate schedule and the corresponding Service Rules and Regulations Relating to the Provision of Delivery Service to Retail Customers.

It is the Company's policy to install street lighting according to the Illuminating Engineering Society of North America (I.E.S.N.A.) recommendations. You have, however, requested that these street lights not be installed according to these recommendations and have, in fact, indicated where you want the street lights located. By signing below, you acknowledge that you have requested a street lighting system that is of your own design and is not the design offered by the Company. It should also be understood that your street lighting design might not meet the recommendations of the I.E.S.N.A.

This installation along Lennie (wo#116248827) consists of:

- **17 - 45 Watt, LED, 4,800 initial lumens, overhead luminaires mounted to 8' arm on wooden poles serviced by overhead secondary conductors. The current monthly Lighting Services Rate schedule fee per lamp is \$3.47.**

**This estimate is valid for 180 days from date of creation.**

***Note: The initial monthly rates for new LED street lighting alternatives are set at the same monthly rates currently in place for equivalent traditional lamp street lights under the Company's tariffs. The election of new LED street lighting option will require additional costs. CenterPoint Energy may seek to recover necessary expenses associated with LED street light installation causing a monthly rate adjustment in the future.***

The additional cost of electrical power and energy must be provided by your Competitive Retailer of choice. Payment of all monthly fees associated with this installation will be paid directly to your chosen Competitive Retailer.

The streetlights will be installed at the general locations depicted on the attached electrical and gas facility layout. Installation of the street lights is contingent on all the street lights being installed at one time. All easements and rights-of way must be clear of trees, stumps, construction debris and equipment, and other obstructions which would interfere with the Company's cable boring operation. If these conditions are not met, our company must ask that the additional construction costs associated with the obstructions be paid. There will also be a charge for all street, sidewalks, and driveway bore's unless others install electrical PVC conduit to our company's specifications. Conduit specifications can be provided upon request.

While our company does attempt to maintain standard locations for the installation of street lighting, it is not always possible to install street lighting at these locations. Any adjustments needed should be discussed and resolved during the pre-construction walk. Any relocation requested can be done if it does not create operating problems and is not objectionable to other parties. All costs associated with relocations after the installation of the street lighting will be borne by the party making the request.

Please reference the attached *Master Contact Data Form* and fill in all required fields. This information is needed to create new or verify existing unique account numbers called *Electric Service Identifiers (ESI's)*. You will be personally notified if you must choose a Competitive Retailer and personally forward the *ESI* number to that Competitive Retailer chosen. If so required, you will be responsible for following the instructions on the *Competitive Retailer Selection Form* that will be forwarded to you with the *ESI* number on it. You will also be responsible for insuring that your chosen Competitive Retailer follows their instructions noted on this same form. During this process, our company does not know which Competitive Retailer you are choosing. This request cannot be scheduled for construction until your Competitive Retailer of choice has made contact with our company per the instructions on the *Competitive Retailer Selection Form*.

The Competitive Retailer, yourself, and I will negotiate the electric energize date of the requested street lighting. You can learn more on how to contact and choose a Competitive Retailer by calling 1-866-797-4839 or viewing the [www.powertochoose.org](http://www.powertochoose.org) website.

If this is in accordance with your understanding and acceptance, please indicate so in the spaces provided below and return this letter and the Master Contact Data Form to the Service Consultant that provided you with these documents.

If you have any questions, please contact me at (713) 945-3253.

**Mail all documentation mentioned in the agreement to:**

**Attn: SOH DPC,  
4700 South Shaver Building I, FL 3,  
Houston, Texas 77034.**

Sincerely,

*David Miranda*

David Miranda  
Senior Service Consultant  
Lighting Design Services Department

**Please print all entries below except for signature.**

Approved and accepted this \_\_\_\_\_ day of \_\_\_\_\_, 2025.

Signature \_\_\_\_\_

Printed Title \_\_\_\_\_ County Judge

Printed Name \_\_\_\_\_ Lina Hidalgo

Mailing Address \_\_\_\_\_

Phone \_\_\_\_\_

# CENTERPOINT ENERGY STREET LIGHTING SERVICE MASTER CONTACT DATA FORM

## REQUESTER CONTACT DATA

(This section to be completed by organization/person requesting services. Please print clearly.)

The below information must be provided before CenterPoint Energy can secure the Electric Service Identifier (ESI) number (s) that will be used to establish a street lighting account. The ESI number (s) will be provided later to the requester's organization contact person, per information to be provided below, for use in choosing a Competitive Retailer of electrical service.

**Provide customer information below:**

**Organization Name:** Harris County Pct. 2 - Light  
(Name that will appear on account: HOA, POA, LTD, CAI, etc.)

**In care of (if applicable):** \_\_\_\_\_

**Contact Person:** Juan Hernandez **Title:** Sr. Director of Public Works Pct. 2

**Phone #:** 713-274-2306 **Fax #:** \_\_\_\_\_

**E-mail address** (optional but highly desired): juan.hernandez@pct2.hctx.net

**Mailing address (where bill should be sent):** 406 Caroline St. Houston, TX 77002  
\_\_\_\_\_

**Does the requestor have an existing Streetlight Account to which the new streetlights should be added? If an existing account is not available or a new, separate account is desired for this request please select No below:**

Yes X No \_\_\_\_\_

**If yes, please provide the twenty-two digit ESI number for the existing account.** (This number can be retrieved from your monthly Streetlight Bill or by contacting the Competitive Retailer that issues your street lighting bill).

**ESI:** 100890107684810SHA4200  
(example: 100890108888880ABC5555)

## COMPANY CONTACT DATA

(This section to be completed by CenterPoint Energy personnel. Please print clearly.)

Service Area Consultant must complete the below information and indicate the type of layout to be provided by LDS when returning this form with facility layout(s).

**PROJECT NAME:** WILLIAM TELL

**SERVICE AREA:** HUMBLE

**SERVICE AREA CONSULTANT:** David Miranda **PHONE#:** 713-945-3253

       IES Layout Needed   x   Non-IES Layout Needed  
  17   - Cobra 45w LED



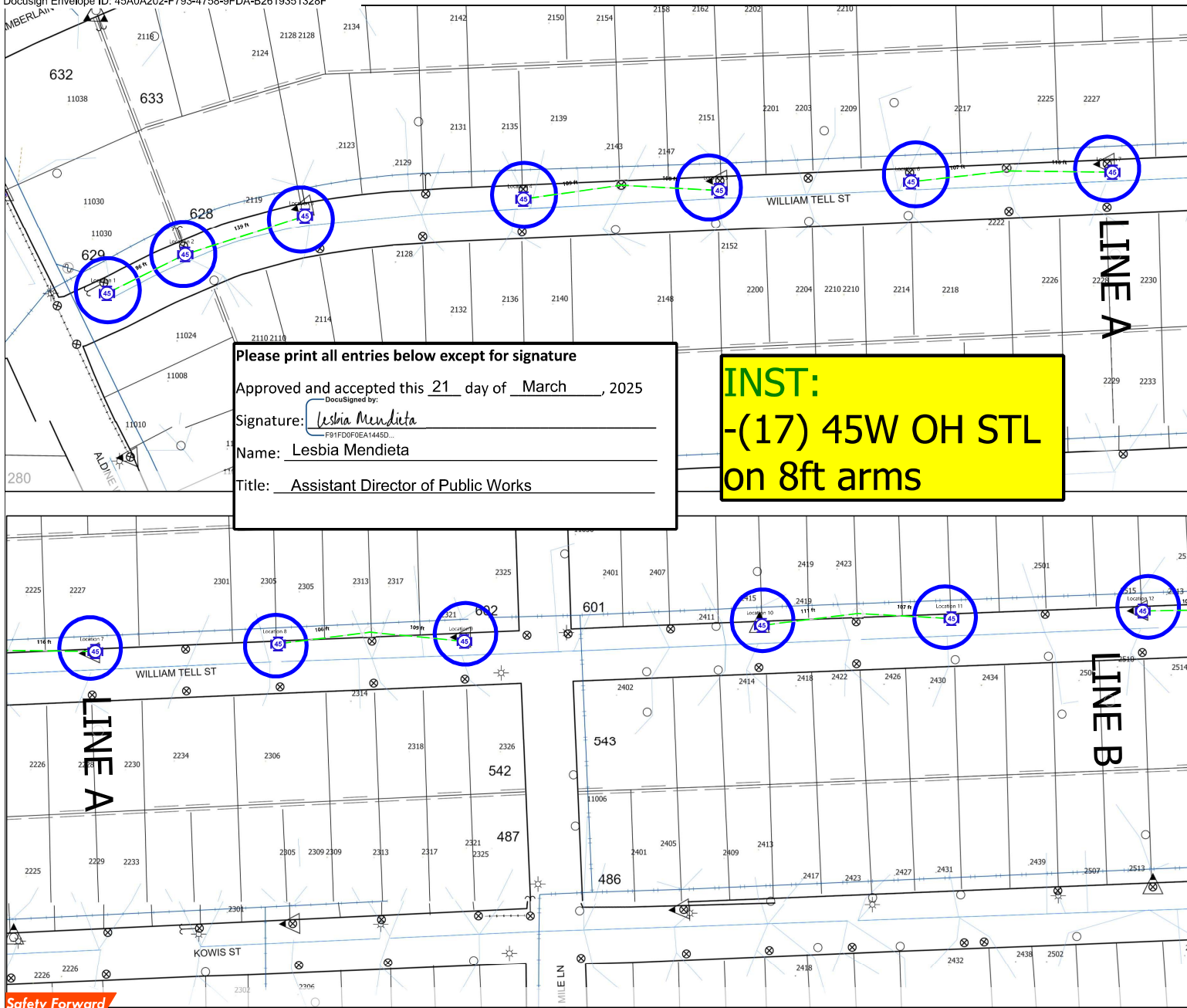

STREET LIGHT PLACEMENT DETAIL  
STREET LIGHT STANDARDS WILL NORMALLY BE INSTALLED IN ROAD RIGHT OF WAY 3' BACK OF CURB AND IN ALIGNMENT WITH SIDE LOT OR REAR PROPERTY LINES, UNLESS THERE IS A CONFLICT WITH DRIVEWAY, FIRE HYDRANT, CATCH BASIN, WATERMETER, OTHER OBSTRUCTIONS, OR WHEN IES RECOMMENDS SPACING REQUIRE OTHERWISE. IN CASE OF CONFLICT WITH O.H. DISTRIBUTION AT REAR OF PROPERTY, STANDARD IS TO BE INSTALLED 8' NORTH OR WEST OF PROPERTY LINE. AT STREET INTERSECTIONS, STANDARDS ARE TO BE INSTALLED BEHIND STRAIGHT SECTION OF CURB 2' FROM TANGENT POINT. STANDARDS SHALL BE PLACED ON STREET SIDE OPPOSITE FROM NORMAL STOP SIGN LOCATIONS.

**NORTH**

LIGHTING DESIGN SERVICES - LIGHTING LEGEND

IMPORTANT NOTE: READ SPECIAL INSTRUCTIONS BELOW AND REFERENCE ANY SPECIAL NEEDS THAT MAY BE SHOWN ON SKETCH.

NEW STREET LIGHT INSTALLATION SYMBOLS

SYMBOLS	QUANTITY	SINGLE LAMP WATTAGE AND TYPE (Circle One Lamp Type for Each Wattage)	LED LEGEND	
●	OH - 0	UG - 0	100W HPS MH	LED
⊗	OH - 0	UG - 0	150W HPS MH	45W OH - 0
⊗	OH - 0	UG - 0	175W HPS MH	95W OH - 0
⊗	OH - 0	UG - 0	250W HPS MH	115W OH - 0
⊗	OH - 0	UG - 0	400W HPS MH	180W OH - 0

DUAL UG ONLY LAMP WATTAGE AND TYPE (Circle One Lamp Type for Each Wattage)

SYMBOLS	QUANTITY	100W HPS MH	150W HPS MH	175W HPS MH	250W HPS MH	400W HPS MH
●	0	0	0	0	0	0
⊗	0	0	0	0	0	0
⊗	0	0	0	0	0	0
⊗	0	0	0	0	0	0

ADDITIONAL INSTALLATION MATERIAL SYMBOLS

TP	0	TERMINAL POLE	R	0	RELAY
X	0	PROPOSED WOOD POLE	⬢	0	PULLBOX
○	0	12KV 35KV PROPOSED OVERHEAD TRANSFORMER			

UNDERGROUND CONDUCTOR (Check One)

Direct Embedded Wire \_\_\_\_\_

Conduit and Wire \_\_\_\_\_

OVERHEAD CONDUCTOR #4 2/C TWIST (UNLESS OTHERWISE NOTED)

1,692.75

EXISTING STREET LIGHT SYMBOLS AND WATTAGES

250 MH 70 100 150 175 250 400

INSTALLATION VOLTAGE: (Circle One Only) 120 240 480

**DDS DESIGN**

WO BY: David Miranda	W.O.#: 116248827
PHONE: 713-945-3253	KEY MAP #: 413V
CELL:	LAMBERT #: 5462
DATE:	SERVICE CENTER: HUMBLE
TYPE: HLC1	SCALE - 1" = 110

Street Light Notes

- All streets must be curbed and guttered prior to the installation of street lighting facilities unless otherwise approved by the Lighting Design Service Department.
- Dedicated street light easements are required along all placement of street lighting facilities when such facilities are installed along private streets. Street lighting will only be installed along private streets that can be accessed for maintenance and only when such a street is constructed in an easement intended to contain a private street, waterlines, sanitary sewer lines, storm sewer, and such other utility or franchise infrastructures as can be accommodated and which, for the purpose of established setback, will be considered to be the equal of a public street.
- The design of all streets, utility easements, and storm sewer easements must be approved by all appropriate reviewing agencies before the installation of street lighting.
- Street lighting will be installed to the recommendations of the Illuminating Engineering Society unless otherwise requested and agreed upon in writing by the requestor of street lighting service.

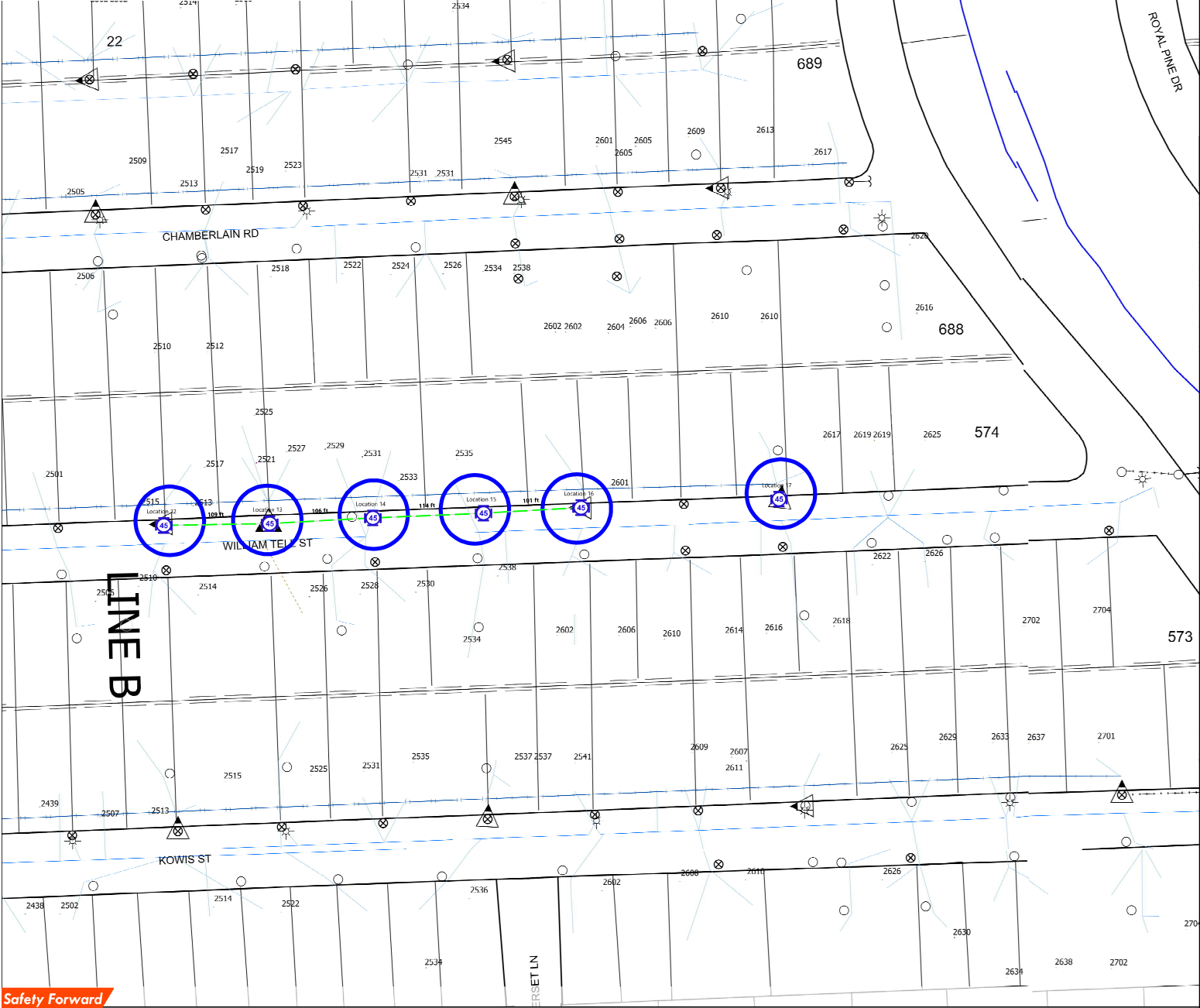

STREET LIGHT PLACEMENT DETAIL  
STREET LIGHT STANDARDS WILL NORMALLY BE INSTALLED IN ROAD RIGHT OF WAY 3' BACK OF CURB AND IN ALIGNMENT WITH SIDE LOT OR REAR PROPERTY LINES, UNLESS THERE IS A CONFLICT WITH DRIVEWAY, FIRE HYDRANT, CATCH BASIN, WATERMETER, OTHER OBSTRUCTIONS, OR WHEN IES RECOMMENDS SPACING REQUIRE OTHERWISE. IN CASE OF CONFLICT WITH O.H. DISTRIBUTION AT REAR OF PROPERTY, STANDARD IS TO BE INSTALLED 8' NORTH OR WEST OF PROPERTY LINE. AT STREET INTERSECTIONS, STANDARDS ARE TO BE INSTALLED BEHIND STRAIGHT SECTION OF CURB 2' FROM TANGENT POINT. STANDARDS SHALL BE PLACED ON STREET SIDE OPPOSITE FROM NORMAL STOP SIGN LOCATIONS.



LIGHTING DESIGN SERVICES - LIGHTING LEGEND  
IMPORTANT NOTE: READ SPECIAL INSTRUCTIONS BELOW AND REFERENCE ANY SPECIAL NEEDS THAT MAY BE SHOWN ON SKETCH.

NEW STREET LIGHT INSTALLATION SYMBOLS					
SYMBOLS	QUANTITY		SINGLE LAMP WATTAGE AND TYPE (Circle One Lamp Type for Each Wattage)		
	OH - 0	UG - 0	100W HPS MH		LED LEGEND
	OH - 0	UG - 0	150W HPS MH	45W	OH - 0 UG - 0
	OH - 0	UG - 0	175W HPS MH	95W	OH - 0 UG - 0
	OH - 0	UG - 0	250W HPS MH	115W	OH - 0 UG - 0
	OH - 0	UG - 0	400W HPS MH	180W	OH - 0 UG - 0

SYMBOLS	QUANTITY	DUAL UG ONLY LAMP WATTAGE AND TYPE (Circle One Lamp Type for Each Wattage)		
	0	100W HPS MH		LED LEGEND
	0	150W HPS MH	45W	0
	0	175W HPS MH	95W	0
	0	250W HPS MH	115W	0
	0	400W HPS MH	180W	0

ADDITIONAL INSTALLATION MATERIAL SYMBOLS					
TP	0	TERMINAL POLE		0	RELAY
X	0	PROPOSED WOOD POLE		0	PULLBOX
	0	12KV 35KV PROPOSED OVERHEAD TRANSFORMER			

	0	UNDERGROUND CONDUCTOR (Check One) Direct Embedded Wire Conduit and Wire		X
	1,692.75	OVERHEAD CONDUCTOR #4 2/C TWIST (UNLESS OTHERWISE NOTED)		

EXISTING STREET LIGHT SYMBOLS AND WATTAGES					
	250 MH		70		100
	150		175		250
	400				
INSTALLATION VOLTAGE: (Circle One Only) 120 240 480					

**DDS DESIGN**

WO BY: David Miranda	W.O.#: 116248827
PHONE:	KEY MAP #: 413V
CELL:	LAMBERT #: 5462
DATE:	SERVICE CENTER: SC
TYPE: HLC1	SCALE - 1" = 99'

Street Light Notes  
-All streets must be curbed and guttered prior to the installation of street lighting facilities unless otherwise approved by the Lighting Design Service Department.  
-Dedicated street light easements are required along all placement of street lighting facilities when such facilities are installed along private streets. Street lighting will only be installed along private streets that can be accessed for maintenance and only when such a street is constructed in an easement intended to contain a private street, waterlines, sanitary sewer lines, storm sewer, and such other utility or franchise infrastructures as can be accommodated and which, for the purpose of established setback, will be considered to be the equal of a public street.  
-The design of all streets, utility easements, and storm sewer easements must be approved by all appropriate reviewing agencies before the installation of street lighting.  
-Street lighting will be installed to the recommendations of the Illuminating Engineering Society unless otherwise requested and agreed upon in writing by the requestor of street lighting service.